

# Shinto.

Desk System.





---

## Introduction to Shinto.

Inspired by the iconic shrines of Japan, our thoughtfully-designed Shinto Desk System assembles effortlessly, to create harmonious work spaces.

Shinto offers a large range of components designed to be easily configured in many different ways to accommodate the needs of your environment and the workstyles it will host.

Surface materials are available in a selection of VE Furniture and Laminex timbers and laminates.

Standard in white powder coated steel frame with legs including levelling glides.

## Understanding Shinto.

### Product Details

Shinto Basic Overview	4
Series One Desk	8
Series Two Desk	11
Series Three Conference Tables	18
Shinto Components	23
Materials + Finishes	28
Shipping + Warranty	30

This guide contains multiple products from the Shinto Desk System range which have been curated into one specification guide for your convenience. Note that each product may be subject to different pricing terms and conditions based on finishes selected.

---

# Shinto Basic Overview

**Shinto Desking System** is a modular design that works to your needs.

---

## Workstation Components + Accessories

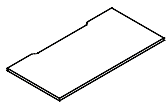

Table Top  
With Cutouts  
▶ Page 24

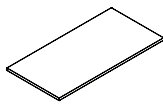
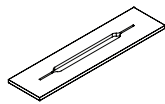
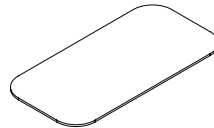

Table Top  
Whole  
▶ Page 24



Screen  
Spacer Mount  
▶ Page 24



Conference  
Table Tops  
▶ Page 24

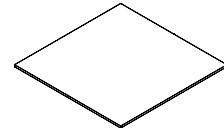

Work Bench  
Table Tops  
▶ Page 24

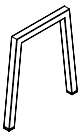

720 Height  
Desk Legs  
▶ Page 23



1050 Height  
Desk Legs  
▶ Page 23

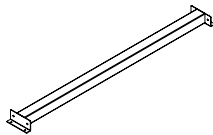

Upper Brace  
Table Top Mount  
▶ Page 25

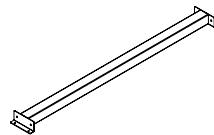

Lower Brace  
Foot Rest  
▶ Page 25

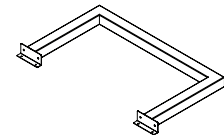

D-extender  
Mounting Brace  
▶ Page 25

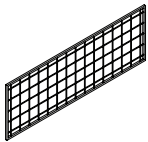

Reo  
Desk Screen  
▶ Page 26

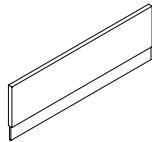

Upholstered  
Desk Screen  
▶ Page 26

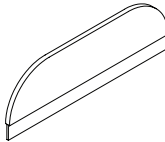

Upholstered  
Desk Screen  
▶ Page 26



Scribe  
Tablet Hook  
▶ Page 26



Scribe  
Tablet  
▶ Page 26

---

## Storage Solutions

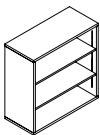

Tana  
Storage System  
▶ Page 27

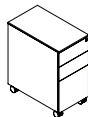

Movida  
Mobile Pedestal  
▶ Page 27

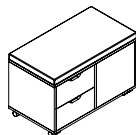

Cubo  
Storage Bench  
▶ Page 27

# Shinto Basic Overview

## Continued

**Basic Shinto components** consist of a Brace, Legs and Table tops.

**Series One** comes standard with a single brace, two legs and a single table top.

**Series Two** comes standard with a double brace, two legs and two table tops.

**Series Two** offers an optional screen mount with a double brace, two legs and two table tops.

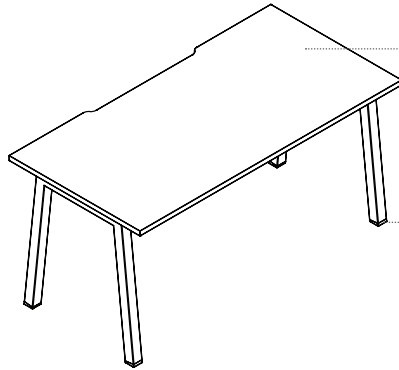

Work surface is 25 mm thick with either a raw Birchply edge or ABS edge in matching laminate colour.

Adjustable glides have a 20 mm adjustability range to compensate for uneven floors.

Optional 600 mm cable cutouts allow cords and monitor mounts to pass behind the table top.

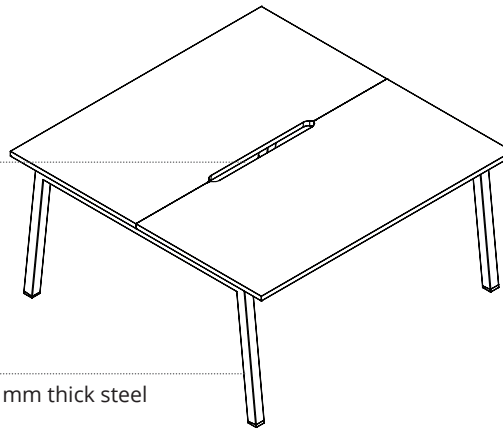

Legs and brace constructed from 50 mm thick steel standard in white powder coat.

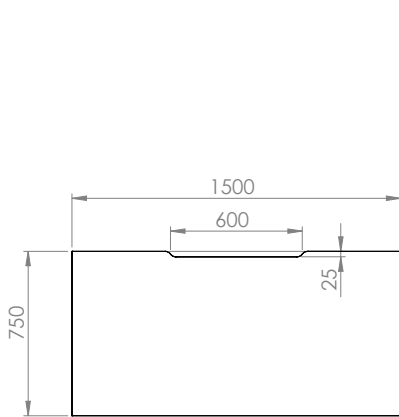

Series One Desk

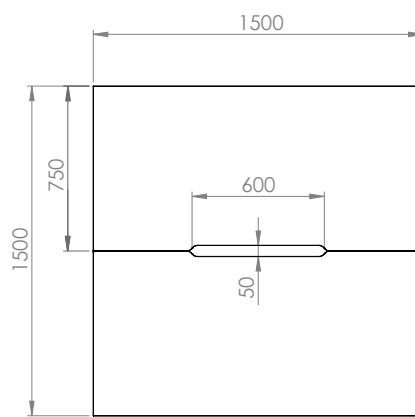

Series Two Desk

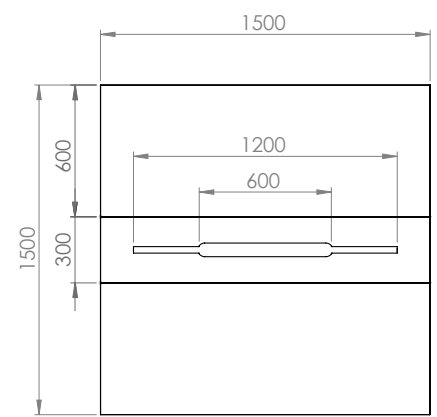

Series Two Desk

# Shinto Basic Overview

## Continued

**Basic Shinto components** consist of a Brace, Legs and Table tops.

**Series Three** comes standard with a double brace, two plus legs and a single table top.

Extra legs and braces may be required depending on the size of your Series Three table.

Power options can be mounted into the work surface upon request.

Large scale, single piece collaboration and conference tables available in three standard sizes.

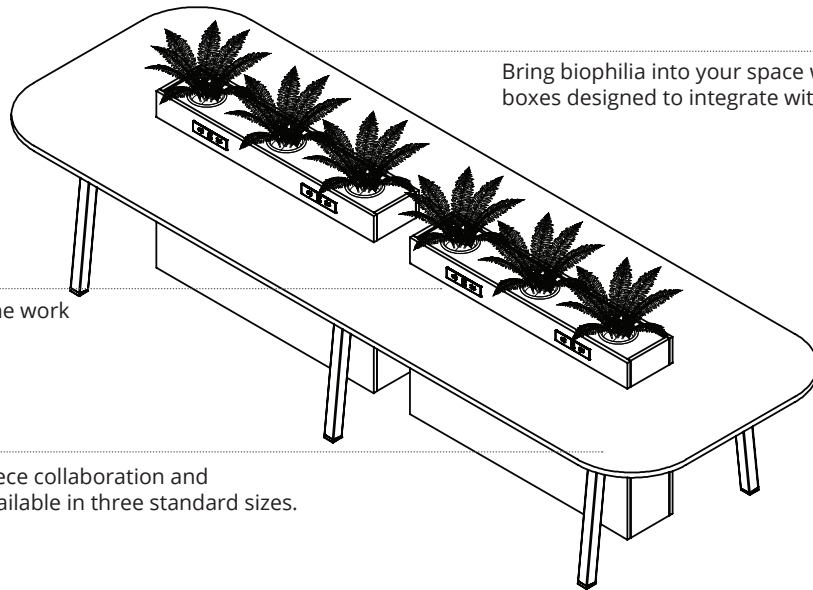

Bring biophilia into your space with a range of planter boxes designed to integrate with Shinto Desk System.

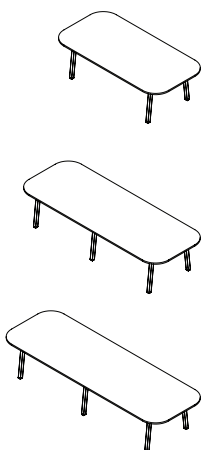

### Series Three Conference Table

W	D	H
2400	1200	720 or 1050

### Series Three Conference Table

W	D	H
3200	1200	720 or 1050

### Series Three Conference Table

W	D	H
3600	1200	720 or 1050

---

# Shinto Basic Overview

## Continued

**Shinto components** are designed to work together to create tailored solutions for your space.

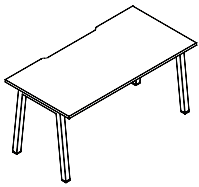

Series One Desk

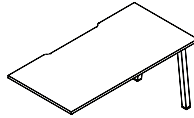

Series One Desk

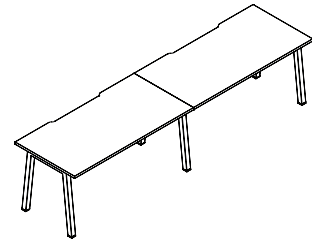

**Series One and an extra Brace, Leg and Table Top** create a workstation for two.

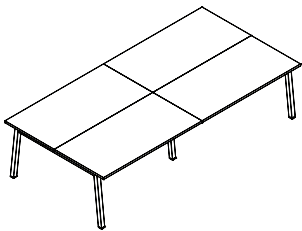

Series Two Desk for Four

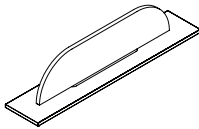

Screen Mount

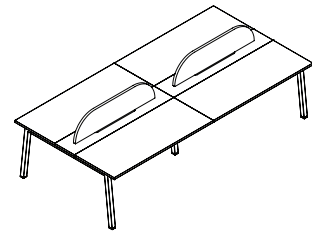

**Series Two for Four and two Screen Mounts** create a focused workstation for four.

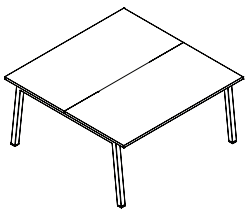

Series Two Desk for Two

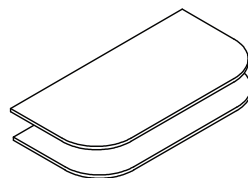

D-end Extension

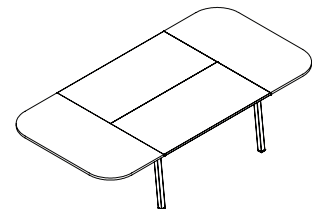

**Series Two and two Soft Curve Tops** create a conference table for six.

---

# Shinto Basic Overview

## Series One Desk

**Series One Desks** consist of a Brace, Legs and Table tops.

**Series One Desks** can be connected unlimitedly, making it easy to expand from a desk for one to an office of one hundred.

**Note:** Power is not unlimited. Additional power feeds may be needed depending on the number of desks connected together.

Cable trays are used to hold power supply and general cords. Each cable tray has the ability to provide extra GPO outlets below the table top.

Data port clips can be set into the cable tray and are accessed through the various cable routing openings.

**Note:** Data cables may need to be run and installed by a qualified data electrician depending on your requirements.

Optional 600 mm cable cutouts allow cords and monitor mounts to pass behind the table top.

**Series One Desks** can be configured with users sitting next to or across from each other.

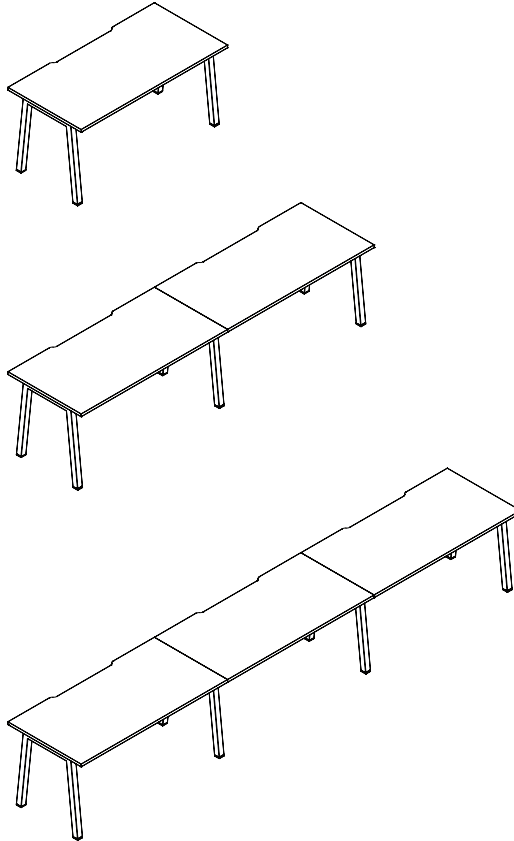



---

## Touchdown Space

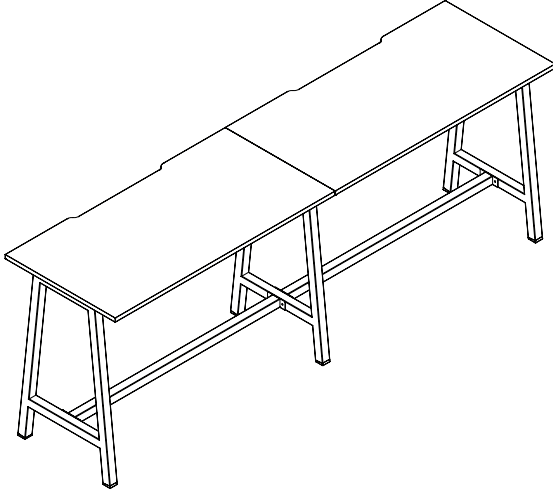

Seamless table tops create a continuous workspace with a minimal footprint perfect for creating touchdown spaces where users can drop in and set up in seconds.

The recommended power solution in this setting is contained above desk for easy access and provides two rotated GPOs and one Inline USB Fast Charge port per person.

Quantity	Code	Description	Selection	
3	SHI-ONE-1025	Series One Leg	1050 H	▶ Page 23
2	SHI-BRA-009	Top Brace	1400 W	▶ Page 25
2	SHI-BRA-010	Lower Brace Foot Rest	1400 W	▶ Page 25
2	SHI-TOP-010	Table Top with Cutout	1500 W x 750 D	▶ Page 24

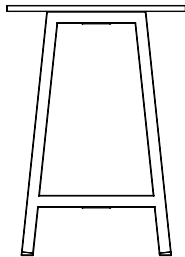

## Zig-Zag Personal Workspace

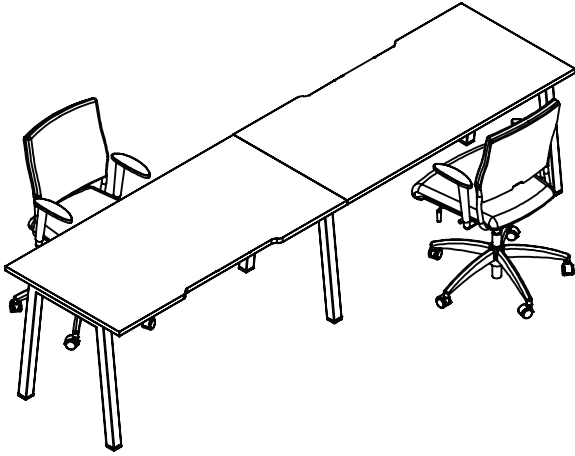

When space is a premium use Single Desk for One with the table top flipped. This configuration give users privacy and optimises your floor plan.

The recommended power solution in this setting is contained above desk for easy access and provides three GPOs per person.

Quantity	Code	Description	Selection	
3	SHI-ONE-695	Series One Leg	720 H	▶ Page 23
2	SHI-BRA-009	Top Brace	1400 W	▶ Page 25
2	SHI-TOP-010	Table Top with Cutout	1500 W x 750 D	▶ Page 24

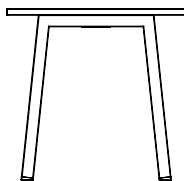

---

# Shinto: Basic Overview

## Series Two Desk

**Series Two Desks** consist of a Brace, Legs and Table tops.

**Series Two Desks** can be connected unlimitedly, making it easy to expand from a desk for two to an office of two hundred.

**Note:** Power is not unlimited. Additional power feeds may be needed depending on the number of desks connected together.

Cable trays are used to hold power supply and general cords. Each cable tray has the ability to provide extra GPO outlets below the table top.

Data port clips can be set into the cable tray and are accessed through the various cable routing openings.

**Note:** Data cables may need to be run and installed by a qualified data electrician depending on your requirements.

Optional 600 mm cable cutouts allow cords and monitor mounts to pass behind the table top.

**Series Two Desks** are configured with users sitting next to and across from each other.

A variety of screen types can be shared between two users when installed on a Series Two Desk with the addition of a Screen Mount Spacer.

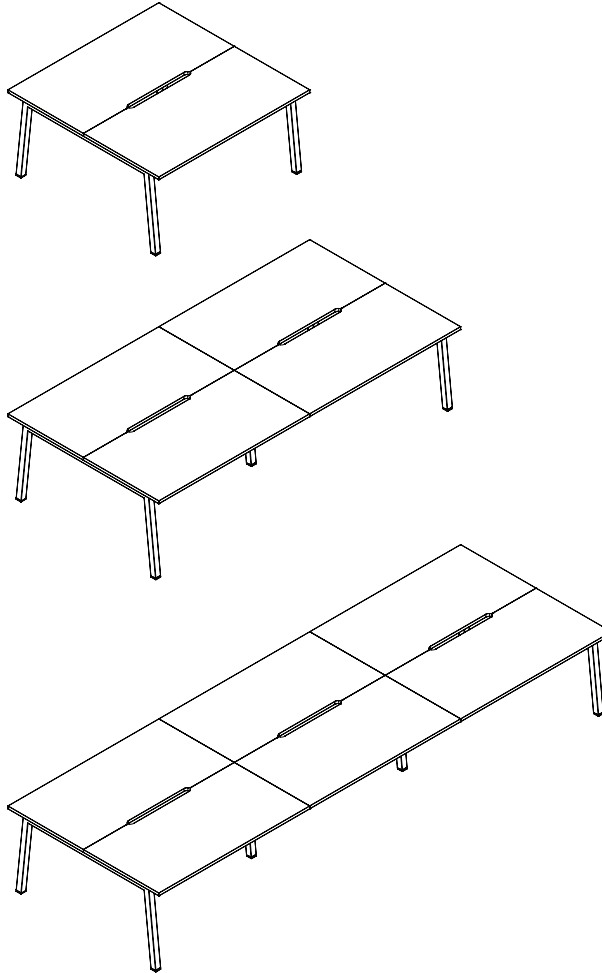

## Personal Work Space

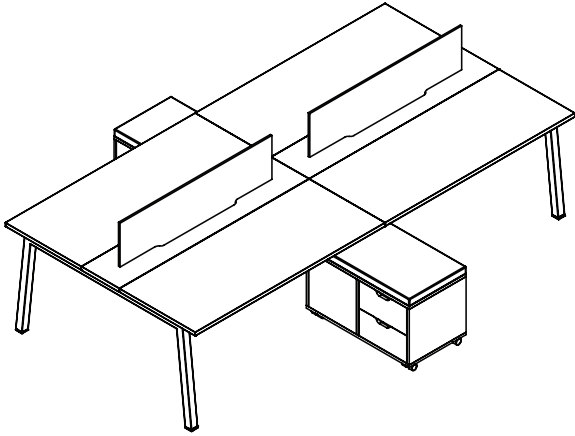

Perfect for maintaining a balance between collaboration and solo work in smaller floorplans. Shinto Personal Work Spaces include solid desk screens to offer privacy but encourage connection with the addition of Cubo Storage Bench seat.

Quantity	Code	Description	Selection	
2	SHI-TWO-695	Series Two Leg	720 H	▶ Page 23
1	SHI-TWO-BRI	Series Two Bridging Leg	720 H	▶ Page 23
4	SHI-BRA-009	Top Brace	1400 W	▶ Page 25
4	SHI-TOP-003	Table Top	1500 W x 600 D	▶ Page 24
2	SHI-MOU-1500	Screen Mount	1500 W	▶ Page 24
2	SHI-SCR-001	Upholstered Square Screen	1200 W	▶ Page 26
2	STO-CUB-814	Cubo Storage Bench	814 W	▶ Page 27

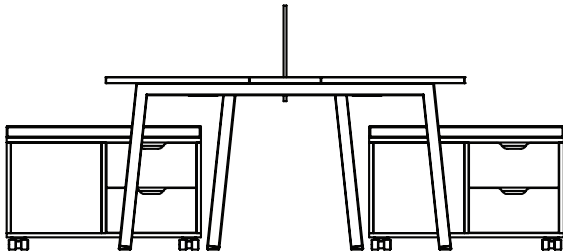

## Connected Work Space

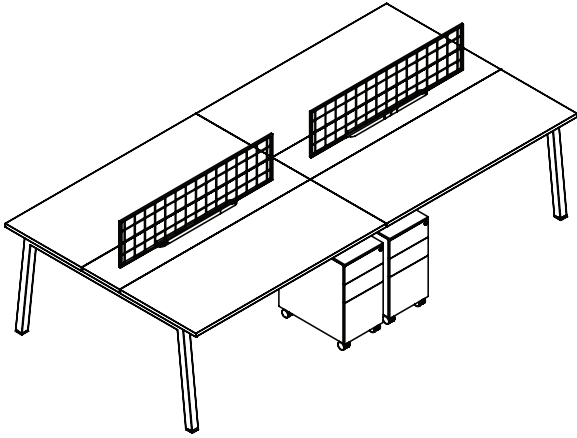

Shinto Connected Work Spaces help create environments that promote personal performance, while supercharging a culture that values collaboration and the creation of new ideas.

Quantity	Code	Description	Selection	
2	SHI-TWO-695	Series Two Leg	720 H	▶ Page 23
1	SHI-TWI-BRI	Series Two Bridging Leg	720 H	▶ Page 23
4	SHI-BRA-009	Top Brace	1400 W	▶ Page 25
4	SHI-TOP-003	Table Top	1500 W x 600 D	▶ Page 24
2	SHI-MOU-1500	Screen Mount	1500 W	▶ Page 24
2	SHI-SCR-003	Reo Square Screen	1200 W	▶ Page 26
4	MOV-PED-300	Movida Mobile Pedestal	300 W	▶ Page 27

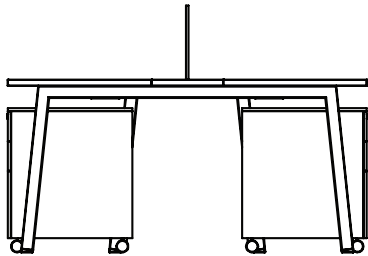

---

## Team Work Space

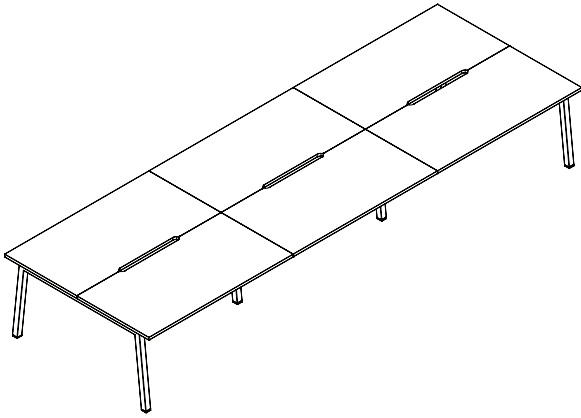

Shinto Team Work Space seamlessly spans the longest spaces with minimal support, providing a sleek look with a minimal design.

Quantity	Code	Description	Selection	
2	SHI-TWO-695	Series Two Leg	720 H	▶ Page 23
2	SHI-TWO-BRI	Series Two Bridging Leg	720 H	▶ Page 23
4	SHI-BRA-009	Top Brace	1400 W	▶ Page 25
2	SHI-BRA-011	Top Brace	1450 W	▶ Page 25
6	SHI-TOP-004	Table Top with Cutout	1500 W x 600 D	▶ Page 24

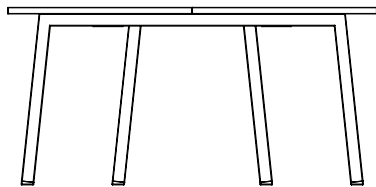

## Open Work Space

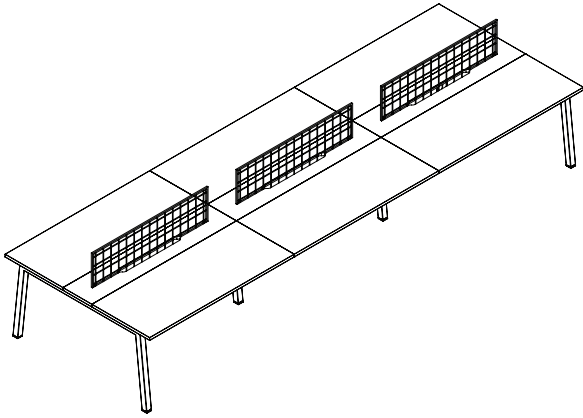

From traditional offices to large open plan spaces, Shinto Open Work Space maximises floor plan restrictions and user comfort to host growing or nomadic teams.

Quantity	Code	Description	Selection	
2	SHI-TWO-695	Series Two Leg	720 H	▶ Page 23
2	SHI-TWO-BRI	Series Two Bridging Leg	720 H	▶ Page 23
4	SHI-BRA-009	Top Brace	1400 W	▶ Page 25
2	SHI-BRA-011	Top Brace	1450 W	▶ Page 25
6	SHI-TOP-003	Table Top	1500 W x 600 D	▶ Page 24
3	SHI-MOUN-1500	Screen Mount	1500 W	▶ Page 24
3	SHI-SCR-003	Reo Square Screen	1200 W	▶ Page 26

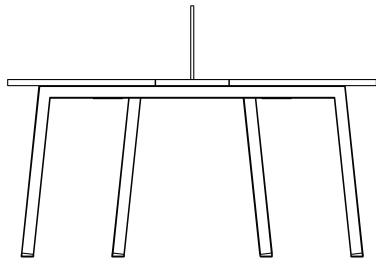

## Production Space

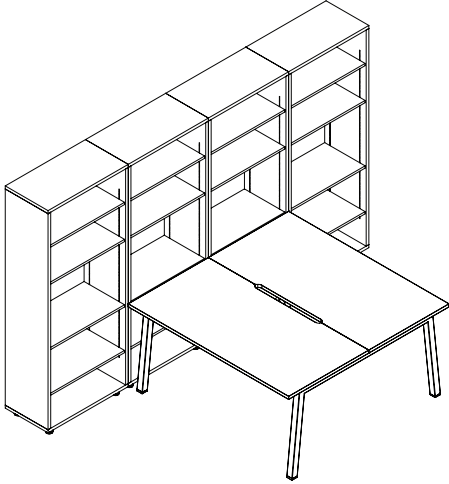

Simple and functional, Shinto Production Space delivers everything you need all within arms reach. Accessing materials and resources becomes a breeze with everything you need stored at your desk.

Quantity	Code	Description	Selection	
2	SHI-TWO-695	Series Two Leg	720 H	▶ Page 23
2	SHI-BRA-007	Top Brace	1350 W	▶ Page 25
2	SHI-TOP-010	Table Top with Cutout	1500 W x 750 D	▶ Page 24
2	SHI-TAN-1800	Tana Storage	1850 H <i>with height adjustable feet</i>	▶ Page 27

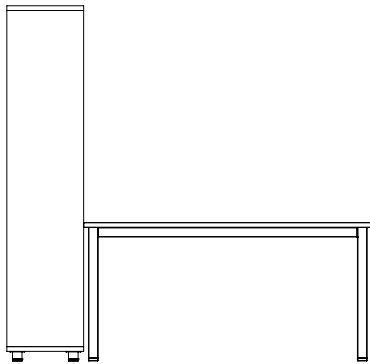



## Combination Space

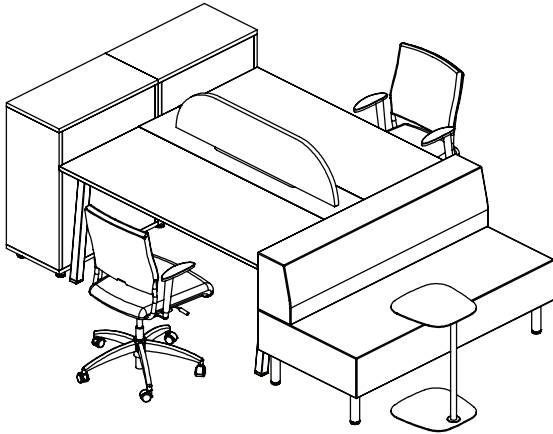

Support diverse workstyle needs and embrace wellbeing in your space. Shinto Combination Spaces blend focused work with breakout zones to encourage users to come together and collaborate.

Quantity	Code	Description	Selection	
2	SHI-TWO-695	Series Two Leg	720 H	▶ Page 23
2	SHI-BRA-007	Top Brace	1350 W	▶ Page 25
2	SHI-TOP-003	Table Top	1500 W x 600 D	▶ Page 24
1	SHI-MOU-1500	Screen Mount	1500 W	▶ Page 24
1	SHI-SCR-002	Upholstered Curve Screen	1200 W	▶ Page 26
2	SHI-TAN-900	Tana Storage	950 H with <i>height adjustable feet</i>	▶ Page 27
1	ORI-SOF	Origami Sofa	1500 W	
1	ELE-PEB	Elements Pebble Table	650 H	

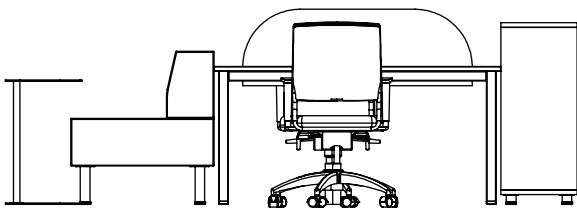

---

# Shinto: Basic Overview

## Series Three Conference Tables + Work Benches

**Series Three Conference Tables and Work Benches** consist of a Brace, Legs and single, large scale Table top.

**Series Three Tables** provide a highly functional conference table or a launchpad for spontaneous collaboration and social interaction in open spaces.

**Note:** Power is not included as standard. Various power configurations may be supplied depending on requirements.

Cable cleats are used to hold power supply and general cords.

Data port clips can be set into mounted power options and are accessed through the various cable routing openings.

**Note:** Data cables may need to be run and installed by a qualified data electrician depending on your requirements.

**Series Three Tables** are available with either a seated or standing height frame option.

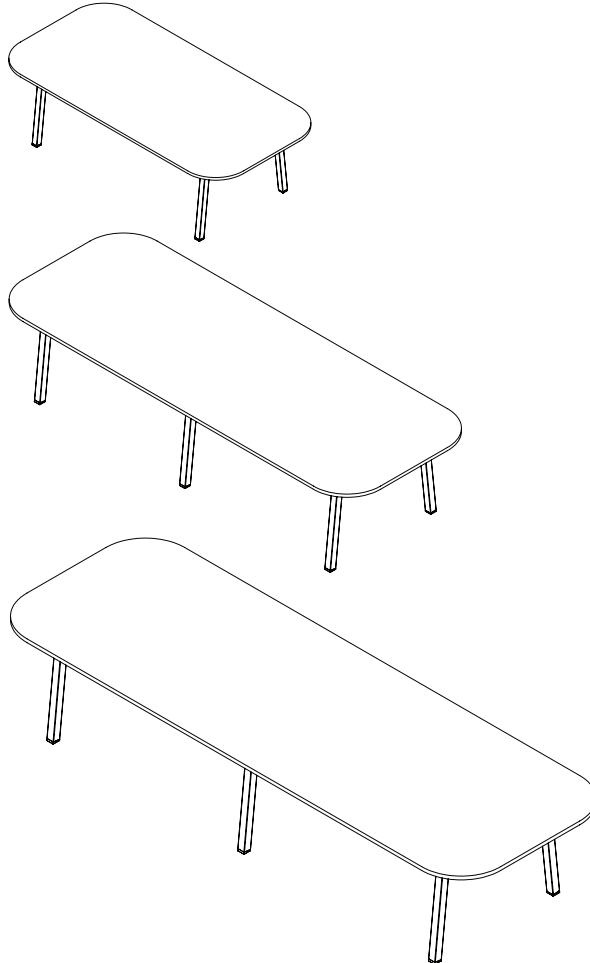

## Breakout Table

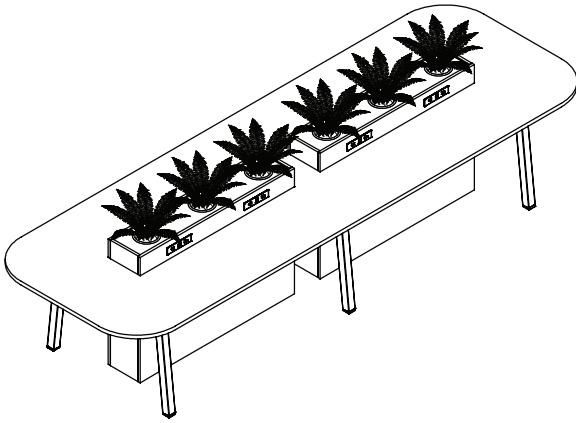

Breakout brings the energy of the outdoors to life in your space. A simple breakout workstation with inbuilt planter boxes provides users with personal power to encourage users to work away from the desk.

Quantity	Code	Description	Selection	
3	SHI-THR-695	Series Three Leg	720 H	▶ Page 23
4	SHI-BRA-007	Top Brace	1350 W	▶ Page 25
1	SHI-CON-3600	Table Top with Cutouts	3600 W x 1200 D	▶ Page 24
2	SHI-PLA-1200	Planter Box	1200 W	

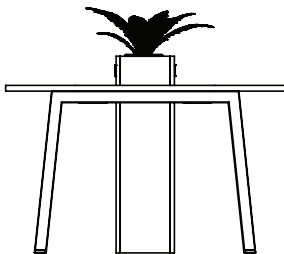

---

## Casual Bench

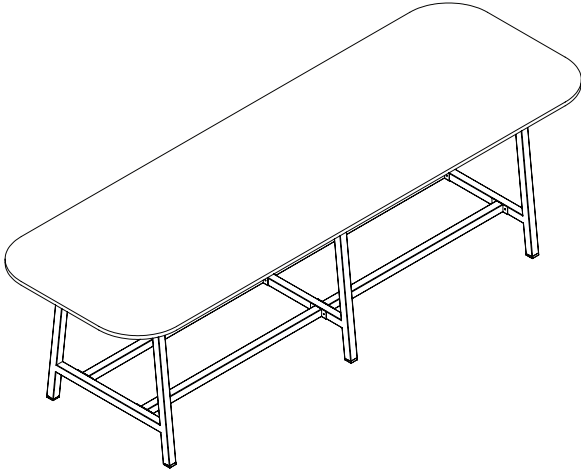

A casual standing height bench designed to bring people together to share ideas or simply take a break, meet or spontaneously collaborate.

Quantity	Code	Description	Selection	
3	SHI-THR-1025	Series Three Leg	1050 H	▶ Page 23
2	SHI-BRA-007	Top Brace	1350 W	▶ Page 25
2	SHI-BRA-008	Lower Brace Foot Rest	1350 W	▶ Page 25
1	SHI-CON-3600	Table Top	3600 W x 1200 D	▶ Page 24

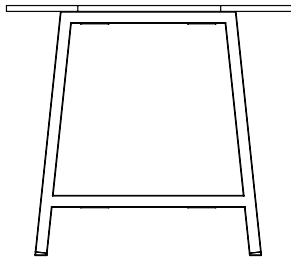

---

## Creator Bench

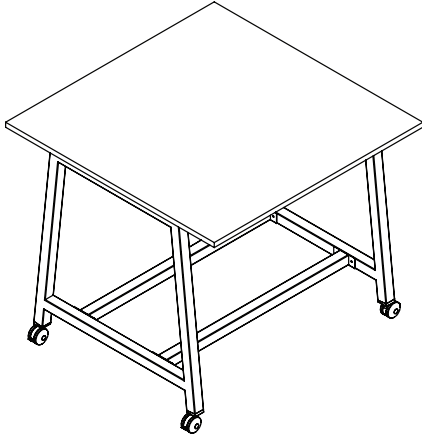

Creator is available in both seated and standing heights and is ideal for any creative, maker or STEAM space where flexibility and adaptability is key.

Quantity	Code	Description	Selection	
2	SHI-THR-1025	Series Three Leg	1050 H <i>Mobile</i>	▶ Page 23
2	SHI-BRA-001	Top Brace	1050 W	▶ Page 25
2	SHI-BRA-002	Lower Brace Foot Rest	1050 W	▶ Page 25
1	SHI-WOR-1200	Table Top	1200 W x 1200 D	▶ Page 24

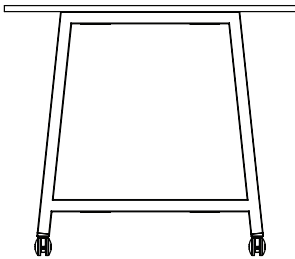

---

## Touchdown Bench



The Touchdown Bench table provides a relaxed and informal gathering point in any environment making it perfect for impromptu meetings and creative endeavours.

Quantity	Code	Description	Selection	
2	SHI-ONE-1025	Series One Leg	1050 H	▶ Page 23
1	SHI-BRA-019	Top Brace	1650 W	▶ Page 25
1	SHI-BRA-020	Lower Brace Foot Rest	1650 W	▶ Page 25
1	SHI-WOR-900	Table Top	1800 W x 900 D	▶ Page 24
2	SCR-HOO-195	Scribe Tablet Hook	195 W	▶ Page 26
4	SCR-TAB-300	Scribe Tablet	300 W	▶ Page 26

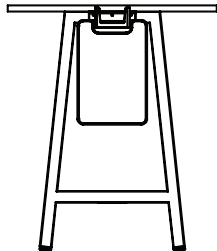

### Series One Leg - 720 High

Dimensions			Item Code
W	D	H	
630	50	695	SHI-ONE-695

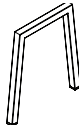

#### Finishes

#### Selections

Standard Powder Coat

▶ Page 28

### Series One Leg - 1050 High

Dimensions			Item Code
W	D	H	
630	50	1025	SHI-ONE-1025

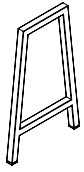

#### Finishes

#### Selections

Standard Powder Coat

▶ Page 28

### Series Two Leg - 720 High

Dimensions			Item Code
W	D	H	
1390	50	695	SHI-TWO-695

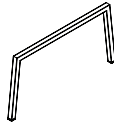

#### Finishes

#### Selections

Standard Powder Coat

▶ Page 28

### Series Two Leg - 1050 High

Dimensions			Item Code
W	D	H	
1390	50	1025	SHI-TWO-1025

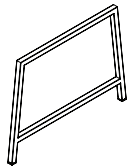

#### Finishes

#### Selections

Standard Powder Coat

▶ Page 28

### Series Three Leg - 720 High

Dimensions			Item Code
W	D	H	
950	50	695	SHI-THR-695

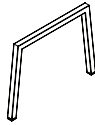

#### Finishes

#### Selections

Standard Powder Coat

▶ Page 28

### Series Three Leg - 1050 High

Dimensions			Item Code
W	D	H	
950	50	1025	SHI-THR-1025

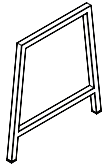

#### Finishes

#### Selections

Standard Powder Coat

▶ Page 28

### Series Two Bridging Leg - 720 High

Dimensions			Item Code
W	D	H	
1210	50	695	SHI-TWO-BRI

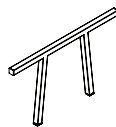

#### Finishes

#### Selections

Standard Powder Coat

▶ Page 28

### Table Top

Dimensions			Item Code
W	D	H	
1200	600	25	SHI-TOP-001
1500	600	25	SHI-TOP-003
1800	600	25	SHI-TOP-005
1200	750	25	SHI-TOP-007
1500	750	25	SHI-TOP-009
1800	750	25	SHI-TOP-011

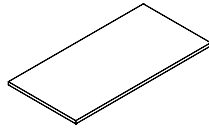

#### Finishes

#### Selections

**Design Note:** 600 mm deep tops are only compatible with **Series One Desks** and **Series Two Desk** plus Screen Mount configurations.

- Standard E0 Laminate ▶ Page 28
- Premium Timbers ▶ Page 28
- ABS Edging ▶ Page 28

### Table Top with Cutout

Dimensions			Item Code
W	D	H	
1200	600	25	SHI-TOP-002
1500	600	25	SHI-TOP-004
1800	600	25	SHI-TOP-006
1200	750	25	SHI-TOP-008
1500	750	25	SHI-TOP-010
1800	750	25	SHI-TOP-012

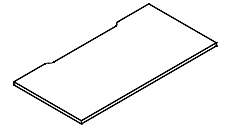

#### Finishes

#### Selections

**Design Note:** 600 mm deep tops are only compatible with **Series One Desks** and **Series Two Desk** plus Screen Mount configurations.

- Standard E0 Laminate ▶ Page 28
- Premium Timbers ▶ Page 28
- ABS Edging ▶ Page 28

### Screen Mount

Dimensions			Item Code
W	D	H	
1200	300	25	SHI-MOU-1200
1500	300	25	SHI-MOU-1500
1800	300	25	SHI-MOU-1800

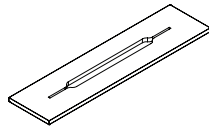

#### Finishes

#### Selections

**Design Tip:** Try using a contrasting finish when designing **Series Two Desk** configurations.

- Standard E0 Laminate ▶ Page 28
- Premium Timbers ▶ Page 28
- ABS Edging ▶ Page 28

### D-end Extension

Dimensions			Item Code
W	D	H	
1500	750	25	SHI-END-1500

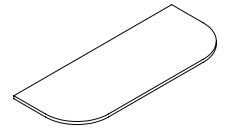

#### Finishes

#### Selections

**Design Note:** Each D-end extension requires a D-end Extender Brace to mount to **Series Two Desk** configurations.

- Standard E0 Laminate ▶ Page 28
- Premium Timbers ▶ Page 28
- ABS Edging ▶ Page 28

### Conference Table Top

Dimensions			Item Code
W	D	H	
2400	1200	25	SHI-CON-2400
3200	1200	25	SHI-CON-3200
3600	1200	25	SHI-CON-3600

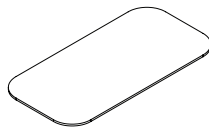

#### Finishes

#### Selections

**Design Note:** 3200 and 3600 conference tables are only available in White Standard E0 Laminate

- Standard E0 Laminate ▶ Page 28
- Premium Timbers ▶ Page 28
- ABS Edging ▶ Page 28

### Work Bench Table Top

Dimensions			Item Code
W	D	H	
1200	1200	25	SHI-WOR-1200
1800	600	25	SHI-WOR-600
1800	900	25	SHI-WOR-900

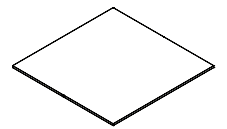

#### Finishes

#### Selections

**Design Note:** 3200 and 3600 conference tables are only available in White Standard E0 Laminate

- Standard E0 Laminate ▶ Page 28
- Premium Timbers ▶ Page 28
- ABS Edging ▶ Page 28



## Top Brace

Dimensions			Item Code
W	D	H	
1050	50	50	SHI-BRA-001
1100	50	50	SHI-BRA-003
1150	50	50	SHI-BRA-005
1350	50	50	SHI-BRA-007
1400	50	50	SHI-BRA-009
1450	50	50	SHI-BRA-011
1500	50	50	SHI-BRA-013
1550	50	50	SHI-BRA-015
1600	50	50	SHI-BRA-017
1650	50	50	SHI-BRA-019
1700	50	50	SHI-BRA-021
1750	50	50	SHI-BRA-023
1800	50	50	SHI-BRA-025
2500	50	50	SHI-BRA-027
2900	50	50	SHI-BRA-029

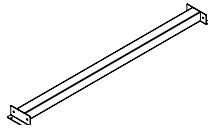

## Lower Brace Foot Rest

Dimensions			Item Code
W	D	H	
1050	50	50	SHI-BRA-002
1100	50	50	SHI-BRA-004
1150	50	50	SHI-BRA-006
1350	50	50	SHI-BRA-008
1400	50	50	SHI-BRA-010
1450	50	50	SHI-BRA-012
1500	50	50	SHI-BRA-014
1550	50	50	SHI-BRA-016
1600	50	50	SHI-BRA-018
1650	50	50	SHI-BRA-020
1700	50	50	SHI-BRA-022
1750	50	50	SHI-BRA-024
1800	50	50	SHI-BRA-026
2500	50	50	SHI-BRA-028
2900	50	50	SHI-BRA-030

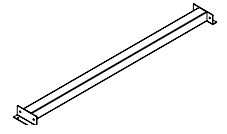

### Finishes

### Selections

Standard  
Powder coat

► Page 28

### Finishes

### Selections

Standard  
Powder coat

► Page 28

## D-End Extender Brace

Dimensions			Item Code
W	D	H	
735	425	50	SHI-BRA-035

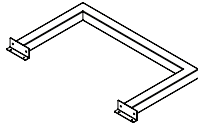

### Finishes

### Selections

Standard  
Powder coat

► Page 28

### Upholstered Square Screen

Dimensions			Item Code
W	D	H	
1200	40	300	<b>SHI-SCR-001</b>

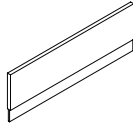

#### Finishes

#### Selections

VE Furniture  
Fabrics

▶ Page 29

### Upholstered Curve Screen

Dimensions			Item Code
W	D	H	
1200	40	300	<b>SHI-SCR-002</b>

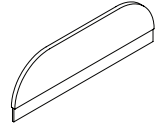

#### Finishes

#### Selections

VE Furniture  
Fabrics

▶ Page 29

### Reo Square Screen

Dimensions			Item Code
W	D	H	
1200	40	300	<b>SHI-SCR-003</b>

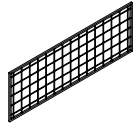

#### Finishes

#### Selections

Standard  
Powder Coat

▶ Page 28

### Bag Hook

Dimensions			Item Code
W	D	H	
40	95	30	<b>BAG-HOO-40</b>



#### Finishes

#### Selections

Standard  
Finish Grey

### Scribe Tablet Hook

Dimensions			Item Code
W	D	H	
195	75	85	<b>SCR-HOO-195</b>



#### Finishes

#### Selections

Standard  
Finish Grey

### Scribe Tablet

Dimensions			Item Code
W	D	H	
300	10	450	<b>SCR-TAB-300</b>



#### Finishes

#### Selections

Standard  
Writable Finish

## Movida Storage Pedestal

Dimensions			Item Code
W	D	H	
300	520	600	<b>MOV-PED-300</b>
390	520	600	<b>MOV-PED-390</b>

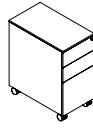

### Finishes

### Selections

Standard Powdercoat [▶ Page 28](#)

## Tana Storage

Dimensions			Item Code
W	D	H	
750	400	900	<b>SHI-TAN-900</b>
750	400	1200	<b>SHI-TAN-1200</b>
750	400	1500	<b>SHI-TAN-1500</b>
750	400	1800	<b>SHI-TAN-1800</b>

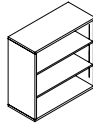

### Finishes

### Selections

Standard E0 Laminate [▶ Page 28](#)

Premium Timbers [▶ Page 28](#)

ABS Edging [▶ Page 28](#)

## Cubo Storage Bench

Dimensions			Item Code
W	D	H	
814	450	516	<b>STO-CUB-814</b>
1212	450	516	<b>STO-CUB-1212</b>

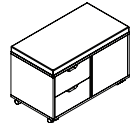

### Finishes

### Selections

Standard E0 Laminate [▶ Page 28](#)

Premium Timbers [▶ Page 28](#)

VE Furniture Fabrics [▶ Page 29](#)

---

# Finishes

## Shinto Desk System.

---

### Powder Coat Standard Inclusion

Timeless, monochromatic and sophisticated. This selection of powdercoat will match any decor. Shinto frame comes standard in Matt White powder coat.

*Custom powder coat available upon request.*



Matt Black



Matt White

---

### 25 mm E0 Laminate Standard Inclusion

Reflecting the most realistic timber grains and brilliant whites this range has been curated to complement any fabric selection.

*18 mm option available upon request.*



Natural Oak



Dark Oak



Gloss Writable

#### **Design Tip:**

*We recommend using one of our Standard Inclusion surfaces with a raw Birchply edge to add a natural warmth to your space.*

---

### 25 mm Premium Timbers

Warm, soft and calming, this range has been curated to reduce stress and restore energy levels through it's biophilic properties.

*18 mm Birchply available upon request.*



Birchply



Rubberwood

---

### 25 mm E0 Laminex Laminate

Inspired by the beauty of nature. This extended range of solid colours and woodgrains are offered to help personalise your space.

Personal and bespoke.



French Navy



Green Slate



Wintersky



Spinifex



Just Rose



Just Lilac



Fox Teakwood



Seasoned Oak



Sublime Teak



Jericho



Oxidised Beamwood



Seasoned Oak

#### **Design Tip:**

*Mix and match Table Top and Screen Mount colours to create configurations that match your brand identity.*

---

# Finishes

## Shinto Desk System.

---

### Atlas Fabric Standard Inclusion

Atlas is a versatile, durable and affordable textile, ideal for heavy duty upholstery where day-to-day life doesn't have to compromise style and comfort.

This collection has been hand selected to work in any workspace.



---

### Haven Fabric

Haven is a soft classic textile that evokes simplicity and comfort. Made from 100% Australian and Mongolian wool, Haven is an attractive and sustainable upholstery choice.

This collection has been curated for creating warm, welcoming spaces with it's natural fibres exuding cosy and comforting style.



---

# Shipping + Warranty

## Shinto Desk System.

### **Shipping.**

Shipping is calculated at the time of order.  
White Glove delivery and installation is extra.  
For more information, visit [vef.com.au](http://vef.com.au).

### **Furniture Warranty.**

To initiate a claim, contact a helpful VE Furniture Account Representative by emailing [info@vef.com.au](mailto:info@vef.com.au) or calling 1300 96 66 40, Monday-Friday 9am to 5pm AEST. For complete warranty information please visit [info.vef.com.au/warranty](http://info.vef.com.au/warranty).

### **Returns + Exchanges.**

To place a return, please contact an Account Representative at [info@vef.com.au](mailto:info@vef.com.au) or give us a ring on 1300 96 66 40 within 30 days of receiving your goods from VE Furniture. Our Account Representatives will happily determine if the product can be returned or exchanged. White Glove Installation fees are non-refundable. For more details on our Terms + Conditions, please visit [vef.com.au/terms-of-service](http://vef.com.au/terms-of-service)



VE Furniture

Showroom  
69-75 Glenvale Crescent | Mulgrave VIC 3170

1300 966 640 | [info@vef.com.au](mailto:info@vef.com.au)